

**girl scouts**   
of southern illinois  
**COUNCIL  
CONNECTIONS**

December 2, 2024

Recording in Process

**WELCOME**  
**Service Unit Managers**

# Agenda

1. Girl Scout Promise
2. Adult Education
3. Community Engagement
4. Product Program
5. Retail
6. Program Engagement
7. Announcements
8. Rallyhood Update

# ADULT EDUCATION



# Adult Education

## Adult Training

### **Camping Out Training:**

Sunday, March 30<sup>th</sup> – Edwardsville

Saturday, April 26<sup>th</sup> – Mt. Vernon

Saturday, May 17<sup>th</sup> – Edwardsville

### **Youth Mental Health First Aid:**

NEW! Saturday, January 11<sup>th</sup>-Effingham (SU511)

Saturday, March 8<sup>th</sup> – Edwardsville

Saturday, March 29 – Edwardsville (VTS)

Saturday, May 17<sup>th</sup> – Mt. Vernon

### **Training By Request:**

- Training by Request (TBR)
- Minimum of six (6) participants

### **Archery:**

Saturday, March 30<sup>th</sup> – Edwardsville

Saturday, April 12<sup>th</sup> – Edwardsville

Saturday, May 17<sup>th</sup> – Edwardsville



 gsfsi



# Adult Education

## SAVE THE DATE – Volunteer Training Summit

- March 29, 2025
- Camp Torqua
- Free camp overnight stays
  - Friday, 3/28 -- Campfire Chat – S'mores & Hot Dogs
  - Saturday, 3/29 – Movie Under the Stars
- Certification Trainings on Sunday, 3/30

# Adult Education

## Adult Training

### New Leader Incentive:

- Complete New Leader Onboarding Training
- First 90 days of Girl Scout Year - - October – December
- Receive Insignia Tab and Membership Pins

### gsLearn Updates:

- New Leader Onboarding Series via gsLearn. Use the [New Leader Onboarding Map](#), located on our website, for support.
- Reminder: Please contact Customer Care if having trouble accessing your gsLearn account.



# Adult Education

## **Volunteer Appreciation**

Saturday, April 12<sup>th</sup> - Have you already been certified in archery but want a little more practice? Come on over to the archery range at Camp Torqua to ask questions and brush up on your archery skills with one of our trainers! Drop in any time between 12:00PM and 2:00PM for this free practice opportunity. Registration End Date: March 31, 2025; Location: Edwardsville, IL.

**Standout Service Unit** - GSofSI Service Units are always hosting amazing events, doing service projects, helping their communities, and so much more. We've created a new opportunity for volunteers to submit one of their Service Unit's activities, events, service projects, or other Girl Scout opportunity to be entered to win the \$50 GSofSI Council Shop gift card and have their submission shared across GSofSI social media accounts and the Volunteer Newsletter! Starting in October 2024, GSofSI will be randomly selecting a different Service Unit from the nominations submitted to council between the first and last day of each month. The winner will be drawn on the first of the next month, and the Service Unit Manager of the winning SU will be notified via email. The submitted activity/event needs to have been held no more than three months prior to submission.

## STAND-OUT SERVICE UNIT



# COMMUNITY ENGAGEMENT





# COMMUNITY ENGAGEMENT

## MY25 Membership Goals and Update

Traditional Troop Girls = **5300**; Adults = **3000**

- Girls = 4,360 girls or 82% to MY25 goal

- Adults = 3,034 adults or 101% to MY25 goal

| Area  | Service Unit Name                             | New Girls | Retained Girls | YTD Total Girls | Total Girl Goal | Girls needed to Goal | Total Girls % to Goal | New Adults | Retained Adults | YTD Total Adults | Total Adult Goal | Adults needed to Goal | Total needed to adults % to Goal |
|---|---|-----------|----------------|-----------------|-----------------|----------------------|-----------------------|------------|-----------------|------------------|------------------|-----------------------|----------------------------------|
| 1 Area002   | SU007_Bond_Fayette_County                     | 19        | 65             | 84              | 90              | 6                    | 93%                   | 11         | 47              | 58               | 55               | (3)                   | 105%                             |
| 2 Area002   | SU101_Alton_Godfrey_Wood_River_Roxana         | 14        | 106            | 120             | 165             | 45                   | 73%                   | 7          | 110             | 117              | 125              | 8                     | 94%                              |
| 3 Area002   | SU102_Granite_City_Madison_Venice             | 12        | 83             | 95              | 115             | 20                   | 83%                   | 9          | 98              | 107              | 110              | 3                     | 97%                              |
| 4 Area002   | SU105_Veney_Calhoun_County                    | 12        | 81             | 93              | 125             | 32                   | 74%                   | 7          | 52              | 59               | 60               | 6                     | 98%                              |
| 5 Area002   | SU106_Bethalto                                | 7         | 30             | 37              | 60              | 23                   | 62%                   | 2          | 32              | 34               | 40               | 6                     | 85%                              |
| 6 Area003   | SU108_Edwardville_Glen_Carbon                 | 34        | 280            | 314             | 400             | 86                   | 79%                   | 30         | 204             | 234              | 220              | (14)                  | 106%                             |
| 7 Area003   | SU109_Troy_St_Jacobs                          | 35        | 120            | 155             | 165             | 10                   | 94%                   | 19         | 107             | 126              | 135              | 9                     | 93%                              |
| 8 Area003   | SU110_Highland                                | 23        | 83             | 106             | 105             | (1)                  | 101%                  | 14         | 71              | 85               | 80               | (5)                   | 106%                             |
| 9 Area003   | SU111_Collinsville_Caseyville_Maryville       | 13        | 49             | 62              | 100             | 38                   | 62%                   | 16         | 60              | 76               | 65               | (11)                  | 117%                             |
| 10 Area003  | SU202_Clarke                                  | 77        | 135            | 162             | 235             | 73                   | 72%                   | 16         | 114             | 127              | 150              | 23                    | 85%                              |
| 11 Area004  | SU201_Ofallon_Shiloh_Fairview                 | 79        | 368            | 447             | 455             | 8                    | 98%                   | 47         | 253             | 300              | 270              | (30)                  | 111%                             |
| 12 Area004  | SU207_Belleville_Swensea                      | 74        | 268            | 342             | 400             | 58                   | 86%                   | 43         | 264             | 307              | 305              | (2)                   | 101%                             |
| 13 Area004  | SU209_Millstart_Columbia_Dupo_Smithton        | 18        | 134            | 152             | 200             | 48                   | 76%                   | 10         | 84              | 94               | 110              | 16                    | 85%                              |
| 14 Area004  | SU210_New_Athens_Marietta_St_Liberty_Freeburg | 8         | 51             | 59              | 85              | 26                   | 69%                   | 4          | 36              | 40               | 40               | 0                     | 100%                             |
| 15 Area004  | SU211_Waterloo                                | 19        | 99             | 118             | 130             | 12                   | 91%                   | 17         | 83              | 100              | 100              | 0                     | 100%                             |
| 16 Area005  | SU006_Centralia                               | 13        | 59             | 72              | 80              | 8                    | 89%                   | 11         | 40              | 51               | 35               | (16)                  | 146%                             |
| 17 Area005  | SU015_Clinton_Washington_County               | 22        | 64             | 86              | 85              | (1)                  | 101%                  | 9          | 31              | 40               | 40               | 0                     | 100%                             |
| 18 Area005  | SU021_East_Marion_County                      | 11        | 30             | 41              | 75              | 34                   | 55%                   | 5          | 31              | 36               | 35               | (1)                   | 103%                             |
| 19 Area005  | SU030_Jefferson_County                        | 15        | 89             | 104             | 125             | 21                   | 83%                   | 4          | 53              | 57               | 58               | (7)                   | 114%                             |
| 20 Area005  | SU054_Perry_County                            | 19        | 65             | 84              | 90              | 6                    | 93%                   | 4          | 41              | 45               | 45               | 0                     | 100%                             |
| 21 Area007  | SU027_Jackson_County                          | 21        | 68             | 89              | 85              | (4)                  | 105%                  | 9          | 77              | 86               | 55               | (31)                  | 156%                             |
| 22 Area007  | SU042_East_Williamson_County                  | 1         | 47             | 48              | 105             | 57                   | 46%                   | 2          | 43              | 45               | 45               | 0                     | 100%                             |
| 23 Area007  | SU051_North_Randolph_County                   | 16        | 69             | 85              | 105             | 20                   | 81%                   | 8          | 36              | 44               | 35               | (9)                   | 126%                             |
| 24 Area007  | SU060_South_Randolph_County                   | 35        | 102            | 137             | 130             | (7)                  | 105%                  | 5          | 71              | 76               | 70               | (6)                   | 109%                             |
| 25 Area007  | SU090_West_Williamson_County                  | 16        | 59             | 75              | 145             | 70                   | 52%                   | 8          | 45              | 53               | 55               | 2                     | 96%                              |
| 26 Area008  | SU031_Johnson_Pope_County                     | 3         | 31             | 34              | 60              | 26                   | 53%                   | 2          | 12              | 14               | 15               | 1                     | 93%                              |
| 27 Area008  | SU045_Masac_County                            | 4         | 19             | 23              | 60              | 37                   | 38%                   | 2          | 20              | 22               | 35               | 13                    | 63%                              |
| 28 Area008  | SU066_Shames                                  | 1         | 44             | 45              | 60              | 15                   | 75%                   | 1          | 28              | 29               | 35               | 6                     | 83%                              |
| 29 Area008  | SU072_Union_Pulaski_Alexander_County          | 5         | 37             | 42              | 70              | 28                   | 60%                   | 1          | 27              | 28               | 30               | 2                     | 93%                              |
| 30 Area008  | SU085_Wayne_Hamilton_White_County             | 20        | 72             | 92              | 130             | 38                   | 71%                   | 4          | 62              | 66               | 80               | 14                    | 83%                              |
| 31 Area009  | SU012_Clay_County                             | 12        | 30             | 42              | 55              | 13                   | 76%                   | 3          | 19              | 22               | 20               | (2)                   | 110%                             |
| 32 Area009  | SU038_Lawrence_Wabash_Edwards_County          | 36        | 86             | 122             | 100             | (22)                 | 122%                  | 17         | 47              | 64               | 45               | (19)                  | 142%                             |
| 33 Area009  | SU051_North_Franklin_County                   | 29        | 143            | 172             | 180             | 8                    | 96%                   | 4          | 40              | 44               | 40               | (4)                   | 110%                             |
| 34 Area009  | SU063_Richland_County                         | 30        | 52             | 82              | 80              | (2)                  | 103%                  | 13         | 22              | 35               | 25               | (10)                  | 140%                             |
| 35 Area009  | SU087_West_Frankfort                          | 11        | 38             | 49              | 60              | 11                   | 82%                   | 8          | 23              | 31               | 35               | (4)                   | 109%                             |
| 36 Area010  | SU511_Effingham_County                        | 18        | 105            | 123             | 135             | 12                   | 91%                   | 4          | 74              | 78               | 75               | (3)                   | 104%                             |
| 37 Area010  | SU521_Western_Coles_Cumberland_County         | 13        | 90             | 103             | 145             | 42                   | 71%                   | 11         | 68              | 79               | 100              | 21                    | 79%                              |
| 38 Area010  | SU526_Eastern_Coles_County                    | 14        | 59             | 73              | 100             | 27                   | 73%                   | 6          | 56              | 62               | 60               | (2)                   | 103%                             |
| 39 Area010  | SU531_Edge_Clarke_County                      | 13        | 75             | 108             | 95              | (13)                 | 114%                  | 7          | 35              | 42               | 40               | (2)                   | 105%                             |
| 40 Area010  | SU544_Crawford_Jasper_County                  | 17        | 70             | 87              | 125             | 38                   | 70%                   | 2          | 39              | 41               | 40               | (1)                   | 103%                             |
| Report data as of 12-2-24   |   | 810       | 3550           | 4360            | 5300            | 940                  | 82%                   | 396        | 2638            | 3034             | 3000             | (49)                  | 101%                             |
| *Council Totals show the number of unique individuals and may not equal the actual column total; some members participate in multiple SUs |   |           |                |                 |                 |                      |                       |            |                 |                  |                  |                       |                                  |
| Report data as of 11-25-24  |   | 792       | 3536           | 4328            | 5300            | 972                  | 82%                   | 391        | 2626            | 3017             | 3000             | (83)                  | 101%                             |

# COMMUNITY ENGAGEMENT

GSofSI Fall  
Membership Blitz

## Fall Membership Blitz

- November 4 – January 6
- Service Units that reach their MY25 Girl Membership goal by January 6 will receive their CHOICE of a STEM activity box or OUTDOORS activity box. *\*\* (This includes any service unit that met its MY25 girl membership goal prior to the start of the campaign)\*\**. During the campaign, service Units with a 20% or more girl membership increase will receive a JOIN GS activity kit.
- GIRL SCOUTS: Introduce a girl to Girl Scouts and both receive a patch when the new girl joins.
- *Please be mindful that these incentives are NOT cumulative, meaning a service unit that meets its girl membership goal by the end of the campaign, but also saw a 20% or more increase in its girl membership won't receive two incentives.*



# COMMUNITY ENGAGEMENT

## Spring Renewal Patch Design Contest

- Deadline is Monday, February 3, 2025
- 18 designs selected
- Open for voting via social media week of February 17th

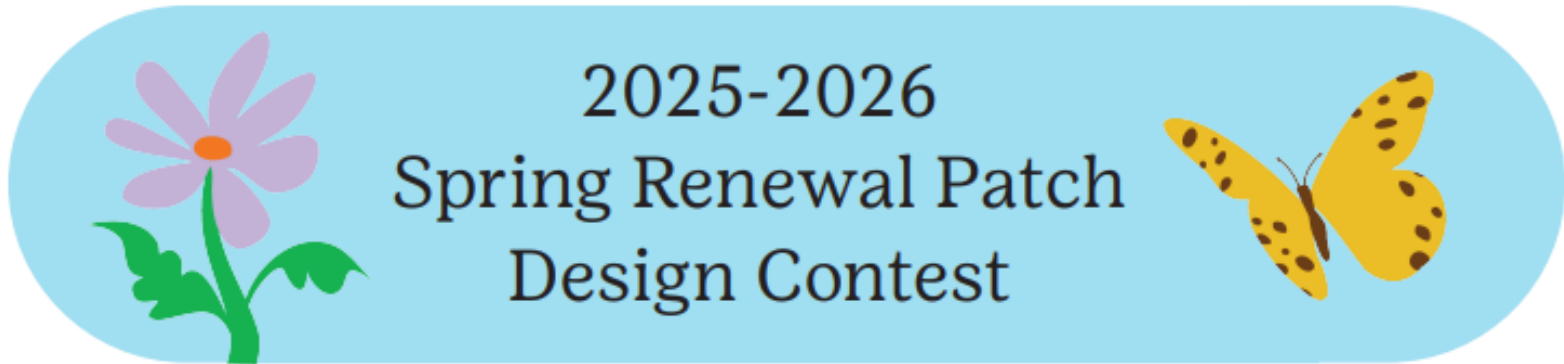

# PRODUCT PROGRAM



# PRODUCT PROGRAM

## 2025 Cookie Program

- Troop Cookie Training is LIVE on gsLearn.
- Troop leaders and troop cookie managers are receiving reminder emails.
- Troop Cookie Training is to be completed before December 18.
- Volunteers who've completed training now have eBudde access.
- eBudde uploads take place every Monday and Thursday throughout the cookie season.
- SUM and SUR can see in Looker who's completed training or SUCM can review uploaded information in eBudde.
- PLEASE NOTE:
  - Troops should review for accuracy and email contact for girls in eBudde. The email listed is the one that will be used for digital cookie. Non-active girls listed in eBudde will not impact any part of the cookie program.
- Check out all of the cookie resources on the council website,  
<https://www.gssofsi.org/en/cookies/find-cookies/for-volunteers-cookie-resources-lbb/gsofsi-cookie-resources.html>

# PRODUCT PROGRAM

## Cookie Zoom Calls

- December 10 - - 6:30 PM - - INTRO to the Cookie Program
- New Cookie Volunteers
- Join Zoom Meeting, <https://us06web.zoom.us/j/81286640436>
- Zoom link is sent out to all uploaded volunteers in eBudde on December 5
  
- Topics:
  - What is a direct cookie sale?
  - How do I place an initial order?
  - How do I conduct a caregiver meeting?
  - Walk-Through of eBudde
  - What to expect during the cookie season

January 7 – Troop Initial Orders Due

January 11 – Digital Cookie Opens

# RETAIL



# RETAIL

## New Shop Hours – Beginning January 2, 2025

- Monday, Tuesday and Thursday – 10:00 AM – 6:00 PM
- Wednesday -10:00 AM – 7:00 PM
- Second and Fourth Saturday - - 9:00 AM – 1:00 PM



## CEO Hand-Crafted Gift

- December 2 - 15 -- Every customer making a purchase in-store, over the phone or online will be entered to win one of three hand-crafted gifts by CEO Loretta Graham.
- Drawing will take place on 12/16/24.

## “Ugly Sweater” Sweatshirts

- Select sizes available -- \$25



## You shop, We ship!

- MY25 Membership Year, purchases of \$50 or more ship for free
- [GSofSI Local Online Shop](#), use code: MEMBER25



# PROGRAM ENGAGEMENT



# PROGRAM ENGAGEMENT

## December Patch Point – Pillar Power

- Girls gain new interests and broaden their skills by exploring activities in each pillar, Life Skills, STEM, Outdoors and Entrepreneurship

<https://www.gssofsi.org/en/members/for-girl-scouts/badges-and-journeys/councils-own-badges-and-patches.html>

## Current Patch Programs – Registration Open

- **Fireside Reading Patch Program - - November 18 – January 5**  
Daisy – Ambassador  
Program Cost: \$0 – Preorder Patch: \$3.00 [GSofSI Council Online Shop](#)  
Deadline: 12/30/24
- **Panda Ventures Patch Program - - November 18 – January 20**  
Daisy – Ambassador  
Program Cost: \$0 – Preorder Patch: \$3.00 [GSofSI Council Online Shop](#)  
Deadline: 1/13/25
- **Winter Challenge Checklist Patch Program - - December 1 – February 28**  
Daisy – Ambassador  
Program Cost: \$0 – Preorder Patch: \$3.00 [GSofSI Council Online Shop](#)  
Deadline: 2/29/25

# PROGRAM ENGAGEMENT

## Preferred Partner Spotlight

- **Cedarhurst Center for the Arts**  
2600 Richview Road, Mt. Vernon
- **1020 Artworks Studio, LLC**  
841 Wabash Avenue, Belleville

## Meet Our New Preferred Partners

### **VicTree Financial**

- Offers virtual courses and workshops to complete various patches.

### **Riverbend Axe Throwing, East Alton**

- Learn to correctly and safety throw axes, and then have time to test your skills!

### **Fabulous Fox Theatre, St. Louis**

- See a Broadway show with your troop! Certain shows may provide a patch and/or an educational encore post-show.

### **T3 Championship Martial Arts, Swansea & Columbia**

- Earn your “Self Defense” Council Patch at one of our martial arts Preferred Program Partners.

# PROGRAM ENGAGEMENT

- **December 19 – January 19– On-Demand Cookie College**
  - Daisy – Ambassador
  - Virtual (Zoom) - -GS Moneyville
  - Cost: \$10-20/girl
  - Deadline: 1/13/25
  
- **January 11 – Woodpecker Walk @ Douglas Hart Nature Center**
  - Daisy – Ambassador
  - Mattoon
  - Cost: \$10/girl; \$3/adult
  - Deadline: 12/30/24
  
- **January 19 – Women In STEM Webinar #2**
  - Daisy – Ambassador
  - Virtual (Zoom)
  - Cost: \$5/girl
  - Deadline: 1/6/25

# PROGRAM ENGAGEMENT

- **January 19 – Cookie Business Live**
  - Daisy – Brownie
  - Virtual (Zoom) - -GS Moneyville
  - Cost: \$20/girl
  - Deadline: 1/13/25
- **January 19 – Cookie Power Live**
  - Junior - Cadette
  - Virtual (Zoom) - -GS Moneyville
  - Cost: \$20/girl
  - Deadline: 1/13/25
- **February 8 – Icy Wonderama Ice Skating**
  - Daisy – Ambassador
  - Edwardsville
  - Cost: \$20/girl/adult (includes admission, skate rental and fun patch)
  - \$15/tags (includes admission and skate rental)
  - Deadline: 1/20/25

# PROGRAM ENGAGEMENT

- **February 15 – Galentine’s Day Paint and Juice Sip**  
Daisy – Junior  
Edwardsville  
Cost: \$20/girl  
Deadline: 1/27/25
  
- **February 15 – Galentine’s Day Paint and Juice Sip**  
Daisy – Junior  
Mt. Vernon  
Cost: \$20/girl  
Deadline: 1/27/25

# PROGRAM ENGAGEMENT

## 2025 Council Trips

- **Georgia Getaway: Journey to Savannah, GA**  
Date: June 11-15, 2025  
Level: Juniors-Ambassadors  
Cost: \$850/girl; \$500/adult  
Deadline to Register: March 3, 2025
- **Pax London**  
Date: June 13-22, 2025  
Level: Seniors-Ambassadors  
Cost: \$3550/girl; \$1775 adult travel advisor  
Deadline to register: January 6, 2025
- **Niagara Navigators: Adventure to Niagara Falls, NY**  
Date: July 20-25, 2025  
Level: Juniors-Ambassadors  
Cost: \$950/girl; \$650/adult  
Deadline to register: March 3, 2025



# PROGRAM ENGAGEMENT

## Upcoming Trainings, Info Nights & More

- 1/27 (& 3/6) – Honor Troop Info Night
- 1/28 – Highest Awards Info Night
- 1/28 - Council Travel Info Night
- 2/4 – Virtual Silver Award Training - 6:00PM
- 2/4 - Virtual Gold Award Training - 7:30PM
- 2/27 - Visionary Voices - Girl-Led Chat
  
- **February 1- PAT Training**
  - Cadette
  - Edwardsville
  - Cost: \$40/girl
  - Deadline: 1/20/25
  
- **February 2- CIT Training**
  - Seniors - Ambassadors
  - Edwardsville
  - Cost: \$40/girl
  - Deadline: 1/20/25



# PROGRAM ENGAGEMENT

## Summer Programs – Registration Now Open

All Council and Service Unit Summer Day and Overnight Camps are open for registration on our event calendar

<https://www.gsofsi.org/en/discover/activities/event-calendar.html/2025-03>

Financial Aid is available

[Day Camp and Overnight Camp Financial Assistance Application](#)

# ANNOUCEMENTS



# DATES TO REMEMBER

## WINTER TOWN HALL MEETING

Wednesday, January 15 – 6:30PM

- Open to all volunteers
- No pre-registration required
- Send any questions to be addressed at this meeting to Ashley Green-Bryant, [agreen-bryant@gssofsi.org](mailto:agreen-bryant@gssofsi.org)

**Topic:** GSofSI Town Hall Meeting w/Council Leadership

**Time:** Jan 15, 2025 06:30 PM Central Time (US and Canada)

**Join Zoom Meeting**

**<https://us06web.zoom.us/j/81647525510?pwd=4AIuSQYSztdve5i4WasqIOI2qrs0ZW.1>**

**Meeting ID: 816 4752 5510**

**Passcode: 851684**

# DATES TO REMEMBER

## GSofSI Office Closures

Thursday, December 12 – All Staff Meeting

Monday, December 23 (12 Noon) – Wednesday, January 1

- GSofSI will re-open on Thursday, January 2, 2025.

Monday, January 20 – Martin Luther King, Jr Holiday

# Let's Chat w/Loretta

January 6

March 3

May 5

*Before Council Connections*

*6:00-6:25PM*



**RALLYHOOD**



# RALLYHOOD UPCOMING TRAININGS & OFFICE HOURS

## **12/2-Immediately following Council Connections meeting (SU Admins)**

### **12/3 6p-7p (SU and Troop Leader Admins)**

Zoom Meeting

<https://us06web.zoom.us/j/87028397548?pwd=4jNVPXwnaoeDpbl8HsXTY4VAGqd8J3.1>

Meeting ID: 870 2839 7548

Passcode: 279300

### **12/4 6p-7p (SU and Troop Leader Admins)**

Zoom Meeting

<https://us06web.zoom.us/j/84318826874?pwd=H7uixjgkEHLJguKBci7dwmsRL32tcR.1>

Meeting ID: 843 1882 6874

Passcode: 661217

### **12/9 5:30p-6:30p (SU & Troop Leader Admins)**

Zoom Meeting

<https://us06web.zoom.us/j/83214595500?pwd=EhmbLt3kEw23MKsTOscix9zoAeJfzb.1>

Meeting ID: 832 1459 5500

# Managing Notifications

## MY RALLYHOOD: SETTINGS “NOTIFICATIONS”

### Notifications

Personalize your [Notification Settings](#) by easily sliding the on/off button next to each option.

Recommend that all users keep the “[My Reminders](#)”, “[Daily Digest](#)” and “[Notify Immediately](#)” turned “on”.

Admins of any Hub or Rally should also keep the “[Join Requested](#)” turned “on” to easily accept people into each Hub or Rally.

Make sure to click [save](#).

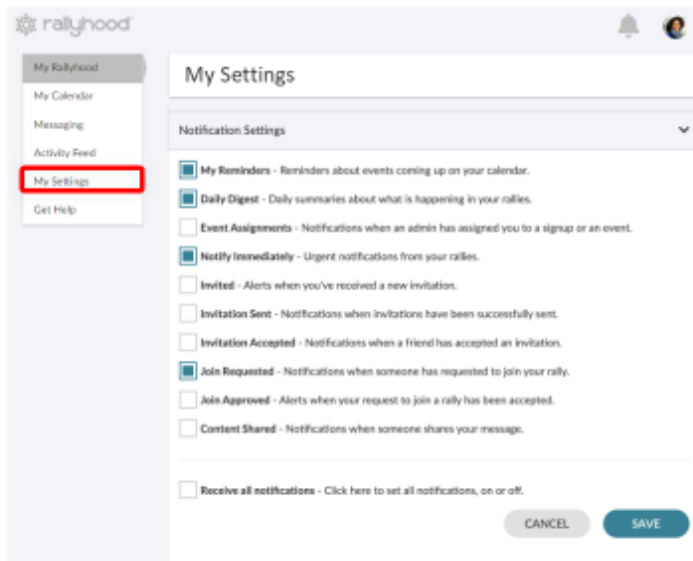



# Managing Notifications

## MY RALLYHOOD: SETTINGS “DAILY DIGEST”

### Daily Digest

You can [merge all of your daily digests](#) into one email for all Hubs and Rallies you are a part of on Rallyhood.

Make sure to click [save](#).

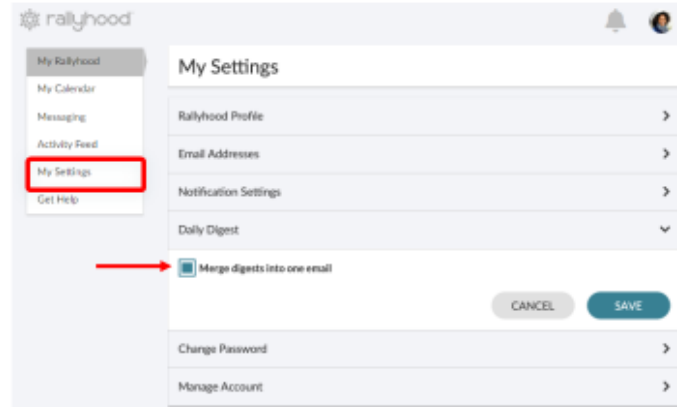

# Visit Our Rallyhood Page

Check out our new [webpage](#) dedicated to all things Rallyhood! Still have questions? Contact Customer Care at 800-345-6858 or [customercare@gsofsi.org](mailto:customercare@gsofsi.org)



SHOP

DONATE

MY GS



Discover ▾

Get Involved ▾

Cookies ▾

Support Us ▾

Members ▾



Rallyhood is our place to connect, share resources, and get inspired with your entire Girl Scouts of Southern Illinois community.

Rallyhood is all-in-one platform that combines many tools Girl Scout service units and troop leaders use to communicate with each other, manage event promotion and registration, share files and photos, collaborate with other volunteers and families, and more!



Thank You!  
**NEXT MEETING:**  
January 6, 2025  
Happy Holidays!

